



490 2ND STREET, 3RD FLOOR
±9,519 RSF

For
LEASE

AVAILABLE NOW

- FULL 3RD FLOOR
- GREAT NATURAL LIGHT
- EXPANSIVE OPEN AREA
- 16 WINDOW LINED OFFICES
- 5 SMALL CONFERENCE ROOMS
- 3 MEDIUM CONFERENCE ROOMS
- 2 KITCHENETTES
- IT CLOSET
- PRIVATE RESTROOMS
- RECEPTION AREA
- FULL HVAC

490 2nd Street, 3rd Floor, located in SoMa, offers great natural light via perimeter windows and interior light well, space has limited South facing views. There is an expansive open area for desks or workstations, and multiple offices and conference rooms. We offer flexible lease terms and highly competitive rental rates.

📍 490 2ND STREET, SAN
FRANCISCO CA 94107

📞 CALL MATT FOR A TOUR

MATT WOLFF

BEACON COMMERCIAL ADVISORS
DRE LIC# 01329156

415-343-2381

matt@beacon-cre.com



490 2ND STREET, 3RD FLOOR, SAN FRANCISCO CA 94107



MATT WOLFF

BEACON COMMERCIAL ADVISORS
DRE LIC# 01329156

415-343-2381

matt@beacon-cre.com



490 2ND STREET, 3RD FLOOR, SAN FRANCISCO CA 94107



MATT WOLFF

BEACON COMMERCIAL ADVISORS
DRE LIC# 01329156

415-343-2381

matt@beacon-cre.com



MATT WOLFF

BEACON COMMERCIAL ADVISORS
DRE LIC# 01329156

415-343-2381

matt@beacon-cre.com

490 2ND STREET, 3RD FLOOR, FLOOR PLAN

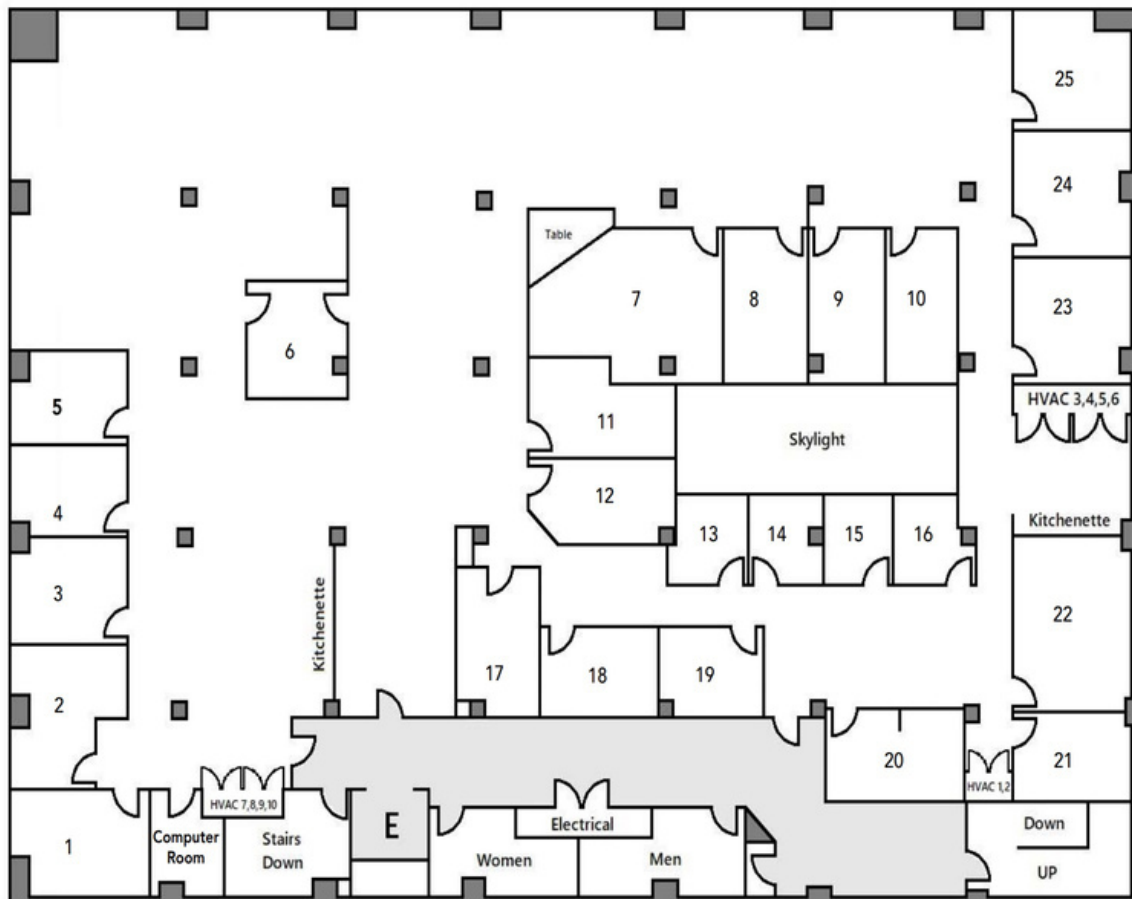



MATT WOLFF

BEACON COMMERCIAL ADVISORS
DRE LIC# 01329156

415-343-2381

matt@beacon-cre.com

ADDRESS

490 2ND STREET, 3RD FLOOR, SAN FRANCISCO, CA 94107

SIZE

± 9,519 RSF

TYPE

CREATIVE OFFICE

TERM

FLEXIBLE

RATE

\$1.50 PSF/MO

DATE AVAILABLE

NOW



Beacon Commercial Advisors and Matt Wolff have obtained the above information from sources believed to be reliable, but no representations of any kind expressed or implied are being made as to the accuracy of such information. All references to square footage, lot size, age of improvements, or income/expenses are approximations only. Buyer should conduct an independent investigation of all pertinent property information. Beacon Commercial Advisors and Matt Wolff bare no liability for any errors, inaccuracies or omissions.